

5 UNIT WORKFORCE CAMP

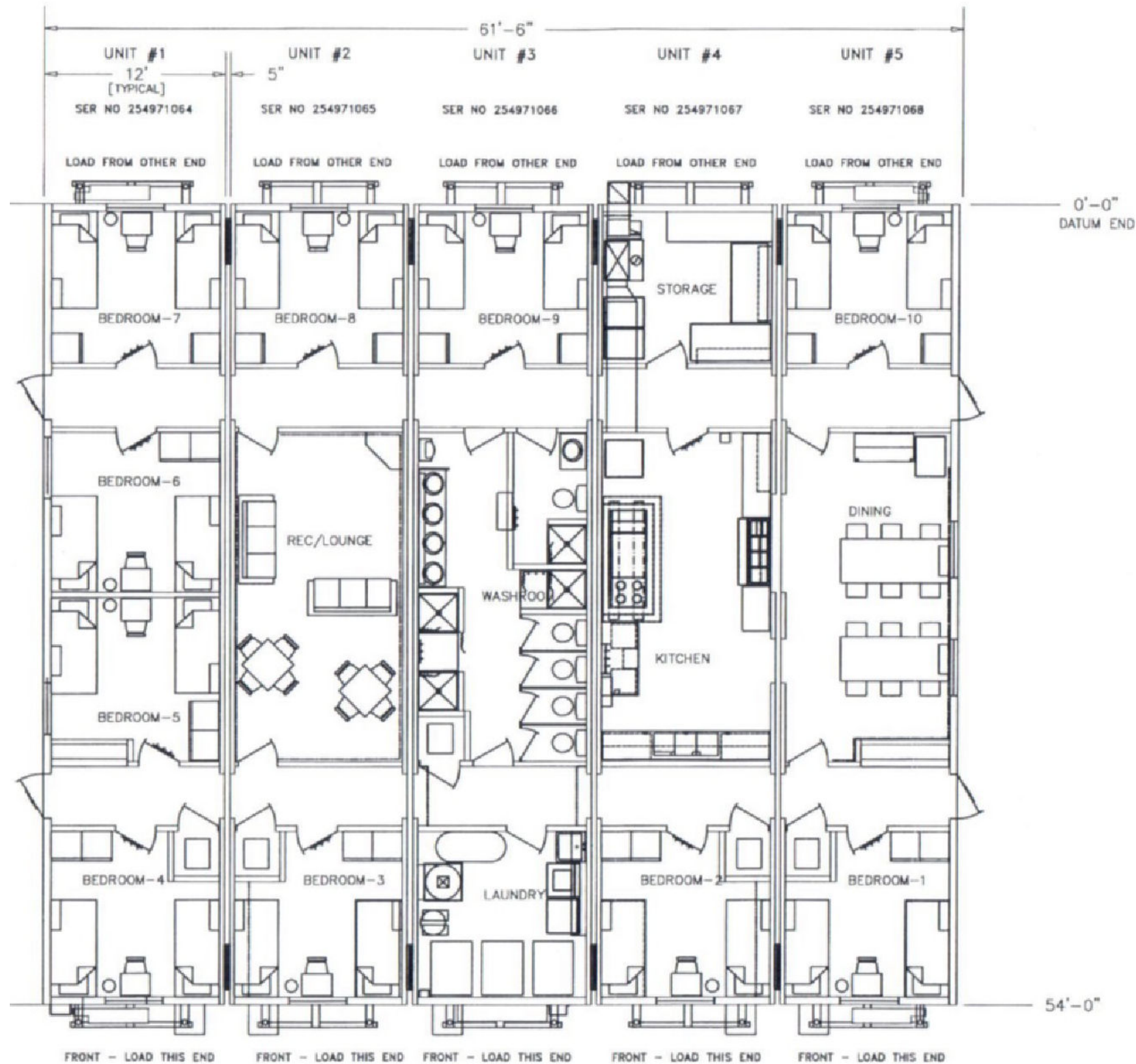

**Parkland Modular  
Equipment & Brokerage LTD.**  
10215 178 Street  
Edmonton AB T5S 1M3  
(780)221-5494



no.	description	date	checked
revisions			

Seal:

Comments:

Client:

Project:  
**5 UNIT  
WORKFORCE CAMP**

Drawing:  
**MAIN FLOOR PLAN**

Date:	Drawn By:
Scale: AS SHOWN	File:
Dimensions: INCHES	Drawing:
Job:	<b>A-1</b>
Program:	
Sheets:	